



WaterStreet

CONDO UNITS

UNIT	MODEL	BEDS	SQ FT.	PRICE	CONDO FEES *
116	GUIGUES	2	905 sq ft	\$457,000	\$466.90
309	BOLTON	2	925 sq ft	\$478,000	\$477.22
413	BEAUSOLEIL	2	1090 sq ft	\$567,000	\$562.36

Parking Spot: \$47.73 / month
Storage Locker: \$1.65 / month

ONE PARKING SPOT INCLUDED

* Condo fees subject to change

Susan Martin
Sales Representative
613-241-3235
By appointment only

E. & OE
May 19, 2020



WaterStreet

INCOME PROPERTIES

Purchase a unit with a tenant in place

UNIT	NAME	BEDS	SQ FT.	LEASE END DATE	PRICE	RENT + PARKING	CONDO FEES *
204	WILBROD	2 BED + DEN	1130 sq ft	Vacant 31-JUL-20	\$627,000	\$2,645	\$582.75
212	MORIN	2 BED	980 sq ft	Month to Month	\$501,000	\$2,189	\$505.58
216	CLARENCE	2 BED	900 sq ft	Month to Month	\$461,000	\$2,145	\$464.30
219	PATRO	2 BED	930 sq ft	Vacant 31-AUG-20	\$476,000	\$2,145	\$479.81
409	BOLTON	2 BED	925 sq ft	Month-to-Month	\$482,000	\$2,345	\$477.22
419	PATRO	2 BED	930 sq ft	Month-to-Month	\$484,000	\$2,250	\$479.81

Parking Spot: \$47.73 / month
Storage Locker: \$1.65 / month

ONE PARKING SPOT INCLUDED WITH PURCHASE

Tenants pay hydro/phone/internet
HST Rebate not applicable

* Condo fees subject to change

Sales Representative
613-241-3235
By appointment only

E. & OE
June 17, 2020

Suite Availability

SEE WHAT'S AVAILABLE NOW

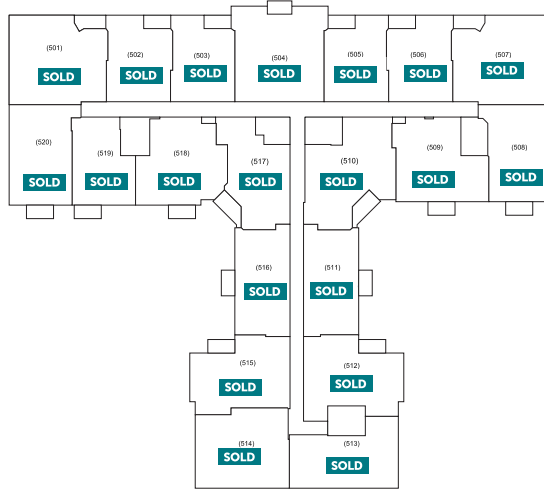

FIFTH

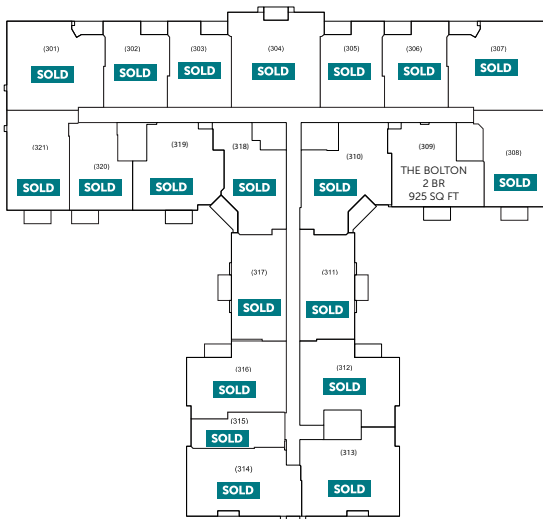

THIRD

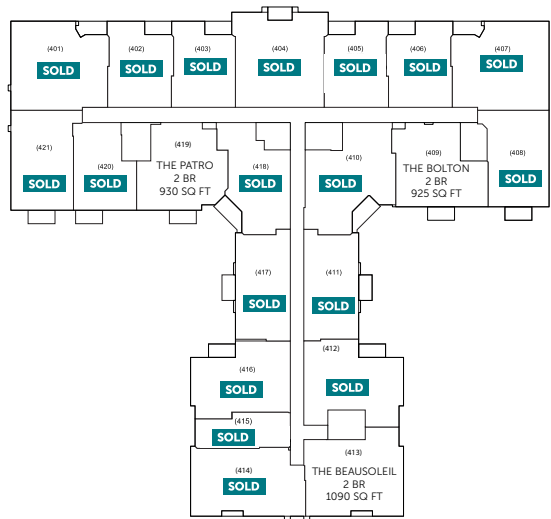

FOURTH

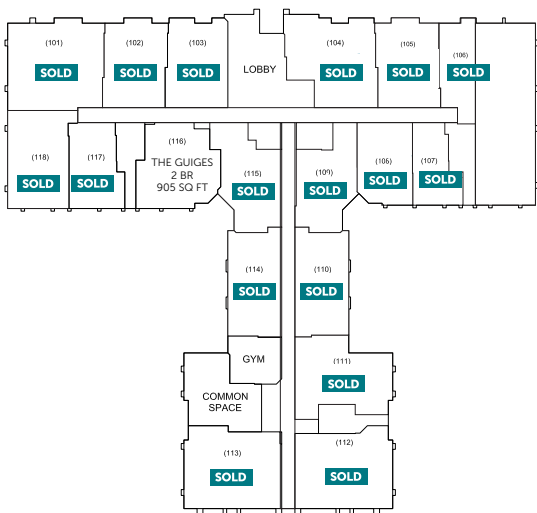

GROUND

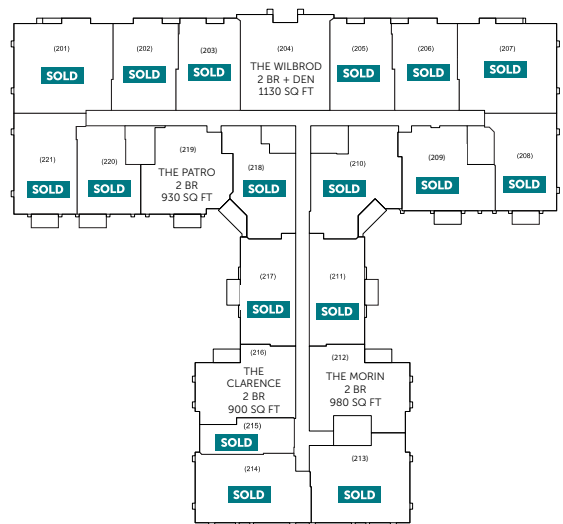

SECOND



Prices and specifications are subject to change without notice. Bulkheads and dropped ceilings will be added as required for mechanical, electrical, and structural elements. Actual usable floor space may vary from the stated floor area. E. & O. E. Updated May 19, 2020

